

Common roof problems



MAINTENANCE

- Poorly installed ridge tiles with cracked or missing mortar, resulting in roof leaks.
- Ridge is untidily waterproofed with acrylic membrane.
- Due to our harsh South African sun, the acrylic waterproofing and re-coating maintenance is required at least every 2 years.
- Result: a permanently unsightly repair as well as time and cost drawbacks.



ROOF LEAKS

- Mortar does not expand and contract with daily temperature variations.
- Hairline cracks form which increase in size.
- Rain penetrates through these cracks.
- Damage caused to the interior of the roof which can cause trusses to rot.



DAMP AND MOULD

- One person produces an estimated 3-4ℓ of water vapour in a day, by using household appliances (dishwashers and tumble dryers) or by cooking and showering.
- Vapour that rises to the top of the building, forms condensation in the roof construction affecting indoor climate and the roof structure (damp, mould etc).

RECOMMENDED ROOF COMPONENTS



Radenshield® Aluminium Membranes

- Radenshield® undertile membranes with added energy-saving benefits
- Reflects 97% of radiant heat, keeping the building up to 10° cooler in summer



EasyFlash with Connection Strip

- A neat, weather-durable, maintenance-free alternative to waterproofing your roof
- Applied to wall-roof junctions
- 15 years maintenance-free when installed with Coverland Connection Strip
- Easy DIY roll & stick application saves time

BRANCHES

Head Office
T +27 11 222 7300
Bloemfontein
T +27 51 492 0210
Brits
T +27 10 492 8800
Cape Town
T +27 21 492 2230

Durban North
T +27 31 565 3260
East London
T +27 43 492 0040
Germiston
T +27 10 492 8780
Pietermaritzburg
T +27 31 489 9880

Polokwane
T +27 15 495 0070
Port Elizabeth
T +27 41 492 0130
Queensburgh
T +27 31 489 9860
Richards Bay
T +27 35 797 2160

Enquiries: info.sa@monier.com
www.coverland.co.za

Part of BMI Group



Dry-fix & storm-proof application for roof ridges



Part of BMI Group

How it works

Dry Ridge refers to the mechanical fixing of the ridge and hip tiles without the use of the traditional mortar application. The Coverland Dry Ridge System offers a leak-proof, maintenance-free solution for your roof ridge and hip-lines. The ventilated channels and high-tearing strength of the Dry Ridge Rolls allow for the natural expansion and contraction of the roof structure in varying weather conditions, while removing trapped air and moisture.

COMPONENTS OF THE DRY RIDGE SYSTEM

The additional components of the system are secured with the dry ridge rolls for maximum protection against the elements.

Ridge Tree: aligns the topmost ridge or hip batten.

Dry Ridge roll: main component, easy to install and secured onto the roof batten. Compact Roll/FigaRoll Plus S.

Ridge/Hip Clips: secure the ridge tiles over the ridge roll.

The result is a storm-proof and maintenance-free ridge and hip-line giving your roof a superior aesthetic finish. No more messy mortar that cracks and leaks.

BENEFITS

100% of roofs in Germany are fixed with Dry Ridge, attesting to the benefits of this method. Tested in our technical centre in Germany.

- Time saving:** Approx 2.5 hours/10m roof. Can be retrofitted.
- Maintenance-Free:** No mould, damp or leaks
- Storm-proof:** Better resistance to varying weather conditions than traditional methods
- Universal Design:** High quality design tested in Monier Technical Facility fitting most roof tile profiles

APPLICATION

The application is time efficient and less labour intensive – an estimated 2.5 hours to fix a 10m Coverland Dry Ridge roof compared to 6 hours for a 10m mortar application. (As tested by Monier Technical Centre, Germany).

Refer fixing instructions or view the short video tutorial available on our website by scanning the QR code.



Dry Ridge rolls

COMPACT ROLL

Best suited for roofs with rolled tile profile e.g. Cupola

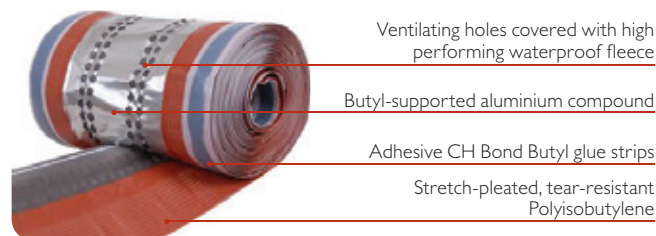

PRODUCT DATA

Material	Aluminium, Polyisobutylene and fleece	
Agrément Certification	2008/343	
Ventilation Cross-section (cm ² /m)	170	
Stretch factor of side strip	Approx. 40%	
Surface Colours	Red / Brown / Black	
Length of Roll (m)	10	
Width of Roll (mm)	280	340
Weight (kg per roll)	3.0	5.0

FIGAROLL PLUS S

Best suited for roofs with flat profile tiles e.g. Elite



PRODUCT DATA

Material	PP Fleece & Coated Aluminium/PET composite foil	
Ventilation Cross-section (cm ² /m)	150	
Stretch factor of side strip	Approx. 20%	
Surface Colours	Red / Black	
Length of Roll (m)	5	
Width of Roll (mm)	210	
Weight (kg per roll)	1.1	

INSTALLATION

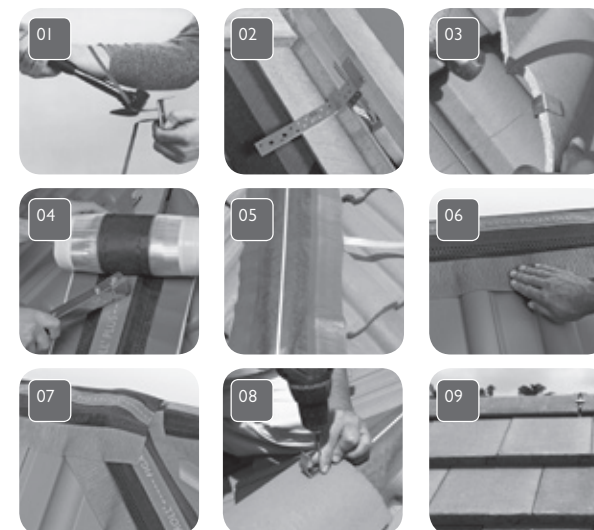

- Measure the pitch** at the ends and in the middle of the ridge. **Bend Ridge Tree** in relation to the angle of the ridge, taking into account the size of the ridge battens (38mm x 38mm).
- Attach the Ridge and Hip Tree** to counter batten/ rafter (for that you need to lift the topmost battens on both sides). Align and fix the remaining Ridge Trees around 600mm of a bow-taut lace. Thereafter the topmost roof battens must be attached again.
- Cut tiles are fixed** durably to the hip structures **with Kro Clips** without drilling. Only nails and hammer needed. Kro Clips are supplied with 30cm length corrosion-resistant binding wire fixed from the Kro Clip to the hip batten/rafter.
- Ensure a clean, dust-free, dry surface** within area of the adhesive edge. **Roll out and align Ridge Roll** onto the ridge or hip batten (Butyl strip down). Staple the middle along the ridge batten following the white line.
- Pull off the adhesive strips**, one side at a time, to expose the CH bond special Butyl glue.
- Press the adhesive edge firmly** and securely by systematically working, for example, from the left side towards the right side. Stick butyl onto all high points of the tiles before moulding into the tile recesses. In the same way as on the ridge-line, Ridge Roll can also be applied on the hip-line.
- Where ridges and hips intersect, lay Ridge Roll onto the ridge/hip end **ensuring sufficient overlap**. At the beginning of the new roll of Ridge Roll overlap the product for at least 5cm.
- Complete the ridge and/or hip with Coverland ridge tile fittings** using 4.5mm diameter wood screws.
- Fix the ridge tiles together with the Ridge Clips** using 4.5mm diameter wood screws until ridge/hip is complete.
- Replace tapered Ridge Clips with **V-Sealing Clips in a V-Ridge system**.

PLEASE NOTE: Surfaces must be clean and dry before installing.